

Weld-on adapter

according to SMS

steel or stainless steel

E 09.03.04

Ed.18.01

Weld-on adapter

Weld-on adapter in steel 1.0460 or stainless steel 1.4404.

Inlet with welding connection, outlet with left-handed male thread

With charge.no and material certificate

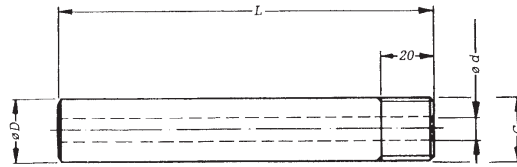

Type	Material	Connection	D	d	L	Code
8060	steel 1.0460	G3/8"	16	6,3	125	80600100
8060	steel 1.0460	G1/2"	20	6,8	125	80600200
8160	stainless steel 1.4404	G3/8"	16	6,5	125	81600100
8160	stainless steel 1.4404	G1/2"	20	8	125	81600200

Pressure rate och temperature

steel - rate PN 64		
Pressure	64 bar	55 bar
Temp	100°C	185°C

stainless steel - rate PN 100		
Pressure	100 bar	30 bar
Temp	120°C	400°C

LH-RH union adapter SMS

Type	Female R	Female L	Material	L	NV	Code
8010	G3/8"	G3/8"	brass	25	22	80100000
8110	G3/8"	G3/8"	SS 2348	25	22	81100000
8020	G1/2"	G1/2"	brass	33	27	80201000
8120	G1/2"	G1/2"	SS 2348	33	27	81200000



Weld-on adapter in steel 1.0460
with union adapter LH-RH in brass



Weld-on adapter in stainless steel 1.4404
with union adapter LH-RH in stainless steel SS 2348